

abbotFox





City Centre, NR1  
*£1,300 PCM*

“

We are a team of genuine individuals who hold a deep passion for both property and marketing. Collectively, we bring over 70 years of experience in the property market of Norfolk and Suffolk. Our affection for both counties runs deep, and we are enthusiastic about sharing our passion with you.

Colin McKenzie | **Branch Partner**











## THE DETAIL\_\_\_\_\_

abbotFox proudly presents this spacious and fully furnished ground-floor apartment.

This well-appointed home features a welcoming entrance hall, an open-plan lounge, dining area, and kitchen, two generously sized double bedrooms, with the master bedroom benefiting from an en-suite, and a stylish family bathroom.

Situated in the heart of Norwich, a historic Cathedral City, residents can enjoy modern shopping malls, a vibrant marketplace, and charming boutique stores nestled within its picturesque lanes and cobbled streets. The city's rich history is evident in its two magnificent cathedrals and iconic Norman castle. Norwich also offers excellent transport links, including a mainline railway station with direct services to London Liverpool Street, and an international airport to the north of the city.



## THE HIGHLIGHTS\_\_\_\_

- Ground floor apartment
- Fully furnished
- Lounge/dining room/kitchen
- Family bathroom and master en-suite

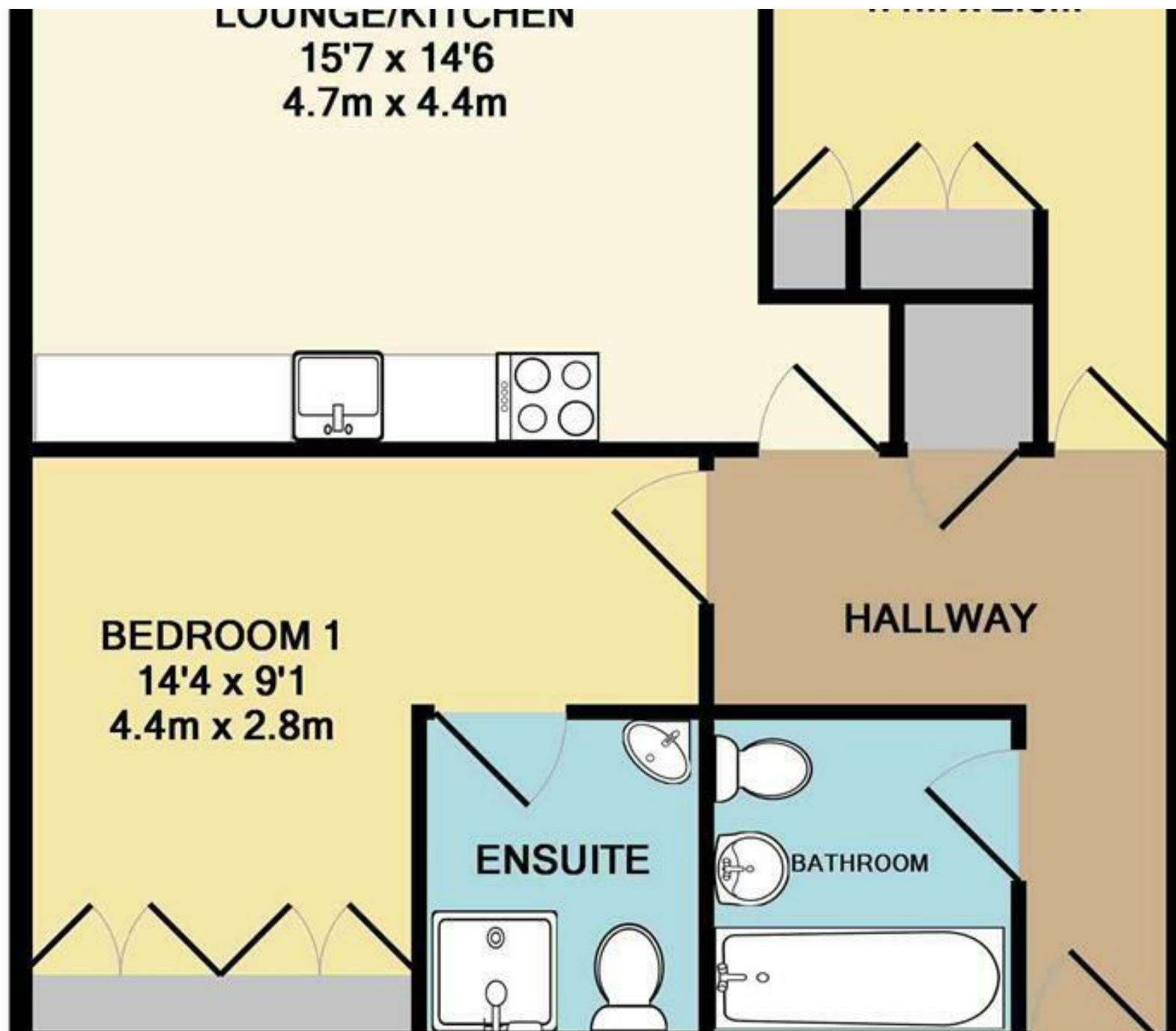

*Let's talk*

01603 660000

[sales@abbotfox.co.uk](mailto:sales@abbotfox.co.uk)

@abbotfox

**EPC RATING - C**

Disclaimer – In accordance with the Property Misdescriptions Act, the company abbotFox gives notice that all descriptions, references to condition, necessary permissions for use and other details are given in good faith and believed to be correct, but any purchaser should not rely on them as statements of fact, and must satisfy themselves by inspection or other means, as to their accuracy.